

DUCT RODDER INTRODUCTION

DCD offers one of the most comprehensive range of Duct Rodders available anywhere in the world - from the smallest 1/8" diameter Fish Tapes to the rugged 1/2" Duct Rodders.

THE ROD

DCD rods are manufactured from state-of-the-art materials formulated to offer the high performance & durability demanded by our customers.

The core of the rod is manufactured by the pultrusion process. This involves impregnating high strength continuous glass fiber filaments with a liquefied resin. The fibers are drawn in to a heated die where the resin matrix is cured, bonding the fibers together and allowing mechanical loads to be transmitted through the matrix and distributed amongst the fibers.

The resulting pultruded rod combines both the high stiffness required to push the rod through long distances of ducting, with the flexibility to handle tight bends without damage. This inner core is then coated with a highly durable, scratch resistant polypropylene sheath which protects the core from mechanical damage.



THE FRAMES

Frames are also a feature of the DCD systems. The four largest sizes incorporate the new EZ-Tip™ feature; a larger footprint for stability; steel brake handles that will last forever; dual rod out-feeding positions and wheels inside the frame width. The two smallest sizes feature frames with the feedout built into the handle. All frames can be laid down on either side. These are just some of the design features that will make every unit more usable and friendly for the end user.

ROD SELECTION

Which is the right rod diameter for any given application? The rod selection is usually governed by several factors including:

- The size of ducting it is to be pushed through
- The distance the rod is to be pushed
- The number and tightness of bends in the ducting
- If the ducting is already occupied by cable

When being pushed through the duct, any rod will tend to form "sine waves", hitting the wall of the duct at certain intervals. Each time the rod comes in contact with the wall of the duct, it causes friction. The friction will build and eventually prevent the rod from being pushed any further. Small rod in large duct will make more frequent contact with the ducting; the same rod in smaller duct will make less frequent contact and therefore less friction so it can be pushed further. Large rod in small ducting is a good situation, but reduced flexibility of the rod may cause increased friction in the tighter bends.

The chart below is a rough guide as to rod diameter selection, but the above factors should all be taken into consideration before making the final selection.

Rod Dia.	Threaded Connection	Tensile Strength of Rod	Typical Strength of Glued Connection	Typical Strength of Screwed Connection	Minimum Bend Radius	Typical Max. Duct Dia.	Max. Length of Push or Pull
1/8"	#12 UNC	1,125 LB	140 LB	-	2"	1-1/4"	150 FT
3/16"	#12 UNC	2,200 LB	350 LB	-	4"	2"	300 FT
1/4"	5/16" UNC	4,070 LB	800 LB	1,050 LB	7"	2-1/2"	400 FT
5/16"	5/16" UNC	7,700 LB	850 LB	1,100 LB	10"	3"	600 FT
3/8"	3/8" UNC	8,580 LB	1,150 LB	1,150 LB	12"	4"	800 FT
7/16"	3/8" UNC	11,000 LB	1,750 LB	1,200 LB	16"	8"	1,200 FT
1/2"	3/8" UNC	13,000 LB	1,900 LB	1,250 LB	18"	10"	1,000 FT

NOTE! ALL DUCT RODDERS ARE CUSTOM BUILT TO ORDER AND ARE NON-RETURNABLE EXCEPT FOR WARRANTY.

ALL REPLACEMENT RODS WILL BE SHIPPED IN A NEW CAGE FOR EASY REPLACEMENT ONTO THE FRAME. EXTREME CARE MUST BE TAKEN WHEN HANDLING LOOSE FIBERGLASS ROD AS IT STORES CONSIDERABLE ENERGY AND MAY CAUSE SEVERE INJURY.



DCD

Toll Free: 1-888-SWIVELS (794-8357) Web Site: www.dcdesign.com

Tel: 604-232-4445

Fax: 604-232-4446

E-mail: sales@dcdesign.com



TUF ROD

52500 SERIES – 1/4" DIAMETER

This unit is mounted in a convenient frame with carrying handle similar to, but larger than the 3/16" unit and the rod is housed in a 24" diameter storage basket.

The end fittings are the same as those offered with the slightly larger 5/16" rod – all stainless steel and with the unique DCD design allowing the fittings to be attached by either screwing or gluing onto the rod core. Thread sizes for all connections are 5/16" UNC.

Minimum bend radius is 7" and sizes available are from 150 ft up to 500 ft. DCD does not recommend pushing lengths over 500 ft unless in relatively small ducting 2" diameter or smaller.

Standard Rodders come complete with stainless steel swivel rod end, female rod end and a pulling eye, while the deluxe version includes accessories as listed below.



Deluxe 1/4" Rod	Rod Length	Weight	Replacement Rod	Deluxe Rod Accessories
52500-150	150 FT	12 LB	52600-150	
52500-200	200 FT	13 LB	52600-200	1 SPLICE CONNECTOR
52500-250	250 FT	14 LB	52600-250	1 FLEXIBLE GUIDE HEAD
52500-300	300 FT	15 LB	52600-300	1 ROLLER GUIDE
52500-350	350 FT	16 LB	52600-350	1 CLEVIS END
52500-400	400 FT	17 LB	52600-400	1 GLUE 3GM
52500-500	500 FT	19 LB	52600-500	1 ROD GRIPPER
				1 ACCESSORY POUCH

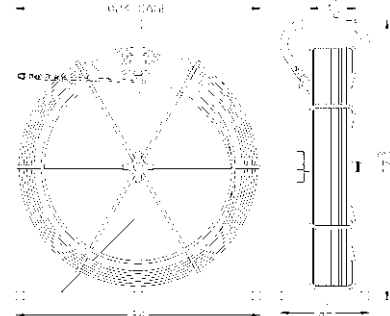

For Standard Rodder units that do not include accessories shown above, add "X" to the part number.

RUF ROD

53500 SERIES – 5/16" DIAMETER

The 5/16" RUF Rod is one of the most popular sizes because of its versatility in both small and medium size ducts. It is the smallest of the wheel frames, yet still well under 3 ft. in height or length so easy to store or load onto your truck.

Although DCD only recommends lengths up to 600 ft., the standard cage will hold up to 800 ft. The longer lengths should only be used in smaller ducts (up to 2-1/2"/dia) and when there are few bends.

The standard unit includes a female rod end, a swivel rod end and a pulling eye. The deluxe version includes accessories as listed below.

All accessories that attach to the rod can be glued on in the traditional manner or they can be clamped on with set screws or they can be glued and screwed for extra security.



Deluxe 5/16" Rod	Deluxe Detectable	Rod Length	Weight	Replacement Regular Rod	Deluxe Rod Accessories
53500-200	53700-200	200 FT	32 LB	53600-200	
53500-250	53700-250	250 FT	34 LB	53600-250	
53500-300	53700-300	300 FT	36 LB	53600-300	
53500-350	53700-350	350 FT	38 LB	53600-350	1 SPLICE CONNECTOR
53500-400	53700-400	400 FT	40 LB	53600-400	1 FLEXIBLE GUIDE HEAD
53500-500	53700-500	500 FT	44 LB	53600-500	1 ROLLER GUIDE
53500-600	53700-600	600 FT	48 LB	53600-600	1 CLEVIS END
53500-700	53700-700	700 FT	52 LB	53600-700	1 GLUE 3GM
53500-800	53700-800	800 FT	56 LB	53600-800	1 ROD GRIPPER
53500-900*	53700-900*	900 FT	60 LB	53600-900	1 ACCESSORY POUCH
53500-1000*	53700-1000*	1000 FT	64 LB	53600-1000	

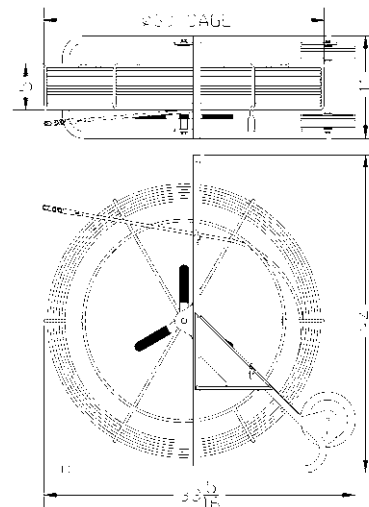

* These two sizes are spooled on a 3/8" (54000) frame, see 54000 Specs for frame dimensions.

For Standard Rodder units that do not include accessories shown above, add "X" to the part number.

Toll Free: 1-888-SWIVELS (794-8357) Web Site: www.dcdesign.com

Tel: 604-232-4445

Fax: 604-232-4446

E-mail: sales@dcdesign.com

DUCT RODDERS & ACCESSORIES



EXTREME DANGER: NEVER USE A DETECTABLE RODDER IN A LIVE ELECTRICAL ENVIRONMENT. ELECTRICAL SHOCK OR DEATH MAY RESULT IF CONDUCTIVE ROD TOUCHES EXPOSED CIRCUIT.

